

A	B	
Diameter	Thickness	Weight
15"	2"	35 lbs
24"	2"	90 lbs
25"	2"	92 lbs
25" w/handle	3"	120 lbs
27" w/handle	2"	110 lbs
30"	2"	130 lbs
30" w/handle	3"	160 lbs
36" w/handle	3"	260 lbs

NON-TRAFFIC RATED SOLID ROUND RISER COVERS

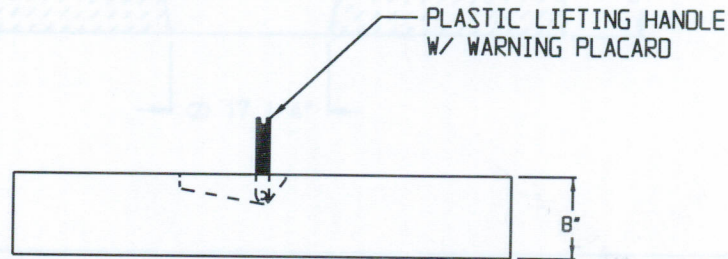
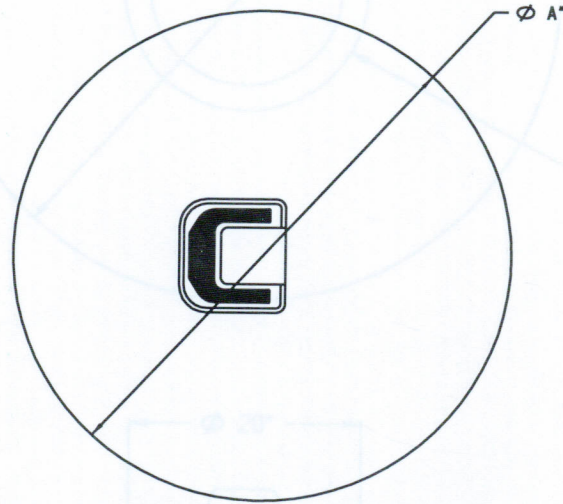

SPECIFICATIONS:

- * Concrete Minimum Compressive Strength-4,000 P.S.I at 28 days.
- * Steel Reinforcement:
Welded Wire Mesh 6" x 6" x W1.4/W1.4 ASTM A-185, or equal



2 COMMERCE DRIVE PO BOX 5133, BROOKFIELD, CT 06804
PHONE: 203 775-0230 FAX: 203 740-2059 WWW.EASTERNPRECAST.COM

PROJECT			
TITLE			
DRAWN BY	BRETT B.	DATE	05-23-05
SCALE	REFERENCE CHART	DWG. NO.	CVR15-36
SHEET	1 OF 1	REV.	B