

# 18" Standard Sump Base

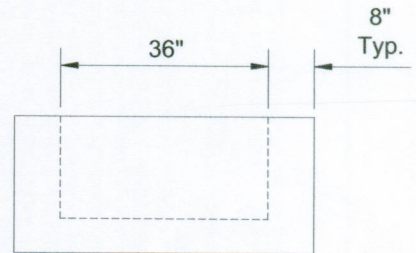
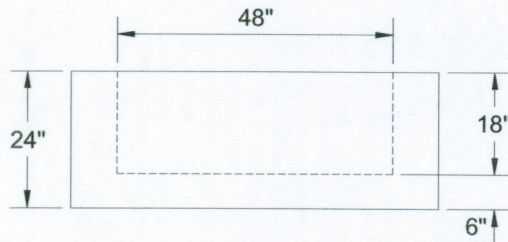
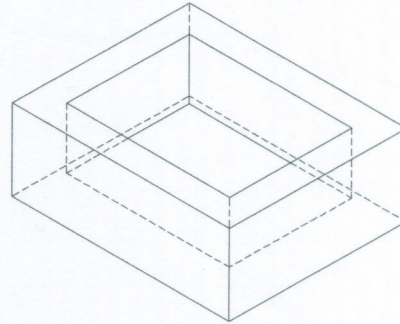
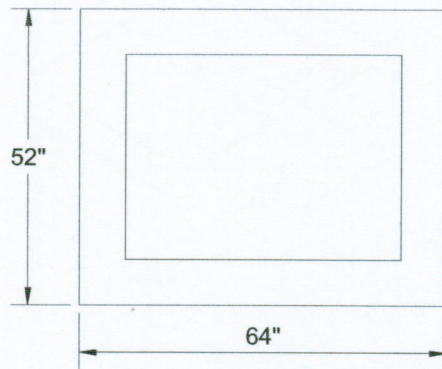

## Specifications:

- \*Concrete minimum strength 4000 psi @ 28 days with fibermesh
- \*Steel Reinforcement : Welded wire mesh 4" x 4" x w4/w4 (.12 sq in/VF)
- \*Design load : H-20
- \*Approx. Weight: 3800 lbs.
- \*2 Recessed utility anchors an interior for lifting.

DWG# SSB18

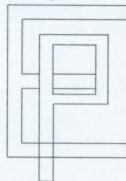

## EASTERN PRECAST CO. INC.

PO. BOX 5133, 2 COMMERCE DR.  
BROOKFIELD CT 06804  
Phone: (203) 775-0230, 775-9380  
Fax: (203) 740-2059  
WWW.easternprecast.com