

H-20 CATCH BASIN BASE SLAB OR TOP SLAB

45" X 56" SLAB H-20

A	B	
LENGTH	WIDTH	WEIGHT
56"	45"	1200 lbs
64"	52"	1550 lbs

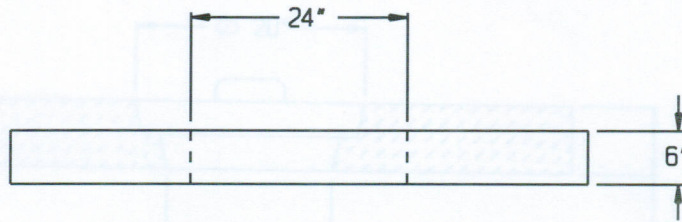
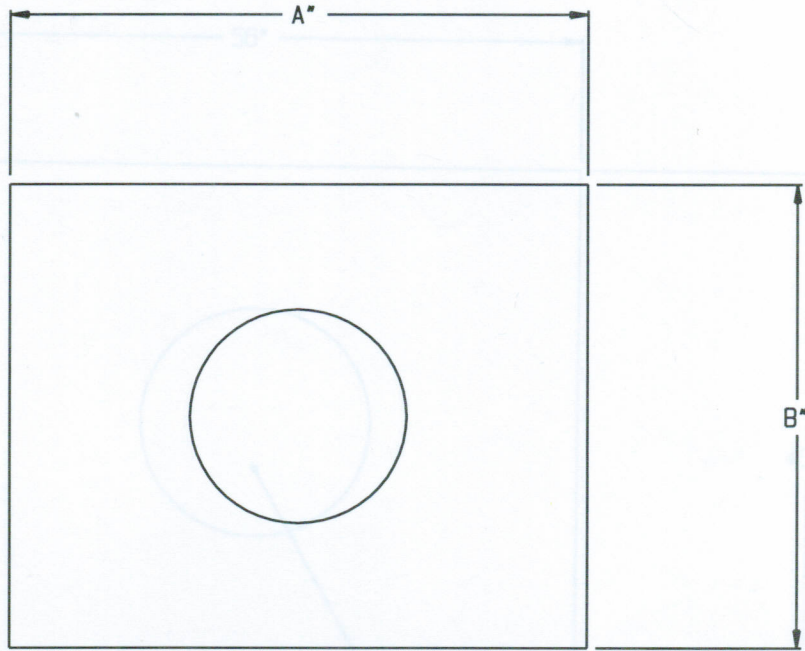

SPECIFICATIONS:

- * Concrete Minimum Compressive Strength-4,000 P.S.I at 28 days.
- * Steel Reinforcement:
 - Welded Wire Mesh 4"x 4"x W1.4/W1.4 ASTM A-185, or equal
 - # 4 Deformed Bar (Gr.60) ASTM A-615, or equal
- * Available Solid, With 20" Inspection Cover, or With 24" Manhole Opening.



2 COMMERCE DRIVE PO BOX 5133, BROOKFIELD, CT 06804
 PHONE (203) 775-0230 FAX (203) 740-2059 WWW.EASTERNPRECAST.COM

PROJECT			
TITLE			
DRAWN BY BRETT B.		DATE 05-23-05	
SCALE	REFERENCE CHART	DWG. NO.	CBSLAB
SHEET	1 OF 1	REV.	B